

Length Unit: mm

d	L	Grip Range		Hole Size Φ	dk	k max	dm max	p min	Minimum Compressive N	Minimum Shear Force N
		min	max							
Φ2.4 +0.08 -0.15	4.0	0.5	2.0	2.5-2.6	4.2-5.0	1.0	1.6	27	700	500
	6.0	2.0	4.0							
	8.0	4.0	6.0							
	10.0	6.0	8.0							
	12.0	7.0	9.5							
	14.0	8.0	11.5							
16.0	10.0	13.0								
Φ3.0 +0.08 -0.15	6.0	1.0	3.5	3.1-3.2	5.4-6.3	1.3	2.1	27	1100	1000
	8.0	3.5	5.0							
	10.0	5.0	7.0							
	12.0	7.0	9.0							
	14.0	9.0	11.0							
	16.0	9.0	12.5							
18.0	12.0	14.5								
20.0	13.0	16.5								
Φ3.2 +0.10 -0.10	6.0	1.0	3.5	3.3-3.4	5.8-6.7	1.3	2.1	27	1200	1100
	8.0	3.5	5.0							
	10.0	5.0	7.0							
	12.0	7.0	9.0							
	14.0	9.0	11.0							
	16.0	9.0	12.5							
18.0	12.0	14.5								
20.0	13.0	16.5								
25.0	15.0	21.5								
Φ4.0 +0.08 -0.15	6.0	1.0	3.0	4.1-4.2	6.9-8.4	1.7	2.6	27	2000	1700
	8.0	3.0	5.0							
	10.0	4.0	6.5							
	12.0	6.0	8.5							
	14.0	7.0	10.5							
	16.0	8.0	12.5							
	18.0	10.0	14.5							
	20.0	12.0	16.0							
	25.0	16.0	21.0							
	30.0	21.0	26.0							
35.0	26.0	30.5								
40.0	30.5	35.0								
Φ4.8 +0.08 -0.15	6.0	1.0	2.5	4.9-5.0	8.3-10.1	2.0	3.1	27	3100	2900
	8.0	2.5	4.0							
	10.0	4.0	6.0							
	12.0	6.0	8.0							
	14.0	8.0	10.0							
	16.0	9.0	12.0							
	18.0	10.0	14.0							
	20.0	12.0	16.0							
	25.0	16.0	21.0							
	30.0	21.0	25.0							
	35.0	25.0	30.0							
	40.0	30.0	35.0							
45.0	35.0	40.0								
50.0	40.0	45.0								
Φ6.4 +0.08 -0.15	8.0	1.5	3.0	6.5-6.6	11.6-13.4	2.7	4.2	27	5700	4900
	10.0	2.0	4.0							
	12.0	3.0	6.0							
	14.0	6.0	8.0							
	16.0	6.0	10.0							
	18.0	8.0	12.0							
	20.0	10.0	14.0							
	25.0	14.0	18.0							
	30.0	18.0	23.0							
	35.0	23.0	28.0							
40.0	28.0	33.0								

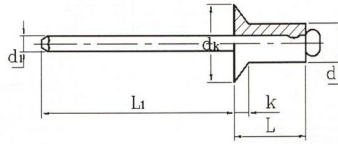

**Steel/Steel
Blind Rivet
Countersunk Head**

Length Unit: mm

d	L	Grip Range		Hole Size Φ	dk	k max	d ₁ max	L ₁ min	Minimum Compressive N	Minimum Shear Force N
		min	max							
Φ3.0 +0.08 -0.15	6.0	1.0	3.5	3.1-3.2	5.4-6.3	1.3	2.1	27	1100	1000
	8.0	3.5	5.0							
	10.0	5.0	7.0							
	12.0	7.0	9.0							
	14.0	9.0	11.0							
	16.0	9.0	12.5							
	18.0	12.0	14.5							
20.0	13.0	16.5								
Φ3.2 +0.10 -0.10	6.0	1.0	3.5	3.3-3.4	5.8-6.3	1.3	2.1	27	1200	1100
	8.0	3.5	5.0							
	10.0	5.0	7.0							
	12.0	7.0	9.0							
	14.0	9.0	11.0							
	16.0	9.0	12.5							
	18.0	12.0	14.5							
20.0	13.0	16.5								
25.0	15.0	21.5								
Φ4.0 +0.08 -0.15	6.0	1.0	3.0	4.1-4.2	6.9-7.5	1.7	2.6	27	2000	1700
	8.0	3.0	5.0							
	10.0	4.0	6.5							
	12.0	6.0	8.5							
	14.0	7.0	10.5							
	16.0	8.0	12.5							
	18.0	10.0	14.5							
	20.0	12.0	16.0							
	25.0	16.0	21.0							
	30.0	21.0	26.0							
35.0	26.0	30.5								
40.0	30.5	35.0								
Φ4.8 +0.08 -0.15	6.0	1.0	2.5	4.9-5.0	8.3-9.5	2.0	3.1	27	3100	2900
	8.0	2.5	4.0							
	10.0	4.0	6.0							
	12.0	6.0	8.0							
	14.0	8.0	10.0							
	16.0	9.0	12.0							
	18.0	10.0	14.0							
	20.0	12.0	16.0							
	25.0	16.0	21.0							
	30.0	21.0	25.0							
	35.0	25.0	30.0							
	40.0	30.0	35.0							
45.0	35.0	40.0								
50.0	40.0	45.0								

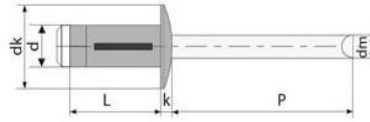

**Steel/Steel
Blind Rivet
Large Head**

Length Unit: mm

d	L	Grip Range		Hole Size Φ	dk	k	dm	p	Minimum Compressive N	Minimum Shear Force N
		min	max							
Φ3.2 +0.10 -0.10	6.0	1.0	3.5	3.3-3.4	9.5 +0.3 -0.7	2.0	2.1	27	1200	1100
	8.0	3.5	5.0							
	10.0	5.0	7.0							
	12.0	7.0	9.0							
	14.0	9.0	11.0							
	16.0	9.0	12.5							
	18.0	12.0	14.5							
	20.0	13.0	16.5							
25.0	15.0	21.5								
Φ4.0 +0.08 -0.15	6.0	1.0	3.0	4.1-4.2	12 +0.5 -1.0	2.2	2.6	27	2000	1700
	8.0	3.0	5.0							
	10.0	4.0	6.5							
	12.0	6.0	8.5							
	14.0	7.0	10.5							
	16.0	8.0	12.5							
	18.0	10.0	14.5							
	20.0	12.0	16.0							
	25.0	16.0	21.0							
	30.0	21.0	26.0							
35.0	26.0	30.5								
40.0	30.5	35.0								
Φ4.8 +0.08 -0.15	6.0	1.0	2.5	4.9-5.0	16 +0.5 -0.1	2.5	3.1	27	3100	2900
	8.0	2.5	4.0							
	10.0	4.0	6.0							
	12.0	6.0	8.0							
	14.0	8.0	10.0							
	16.0	9.0	12.0							
	18.0	10.0	14.0							
	20.0	12.0	16.0							
	25.0	16.0	21.0							
	30.0	21.0	25.0							
	35.0	25.0	30.0							
	40.0	30.0	35.0							
45.0	35.0	40.0								
50.0	40.0	45.0								