

**Steel/Steel  
Hem-Firm Type  
Blind Rivet  
Dome Head**

Length Unit: mm

d	L	Grip Range		Hole Size Φ	dk	k	d <sub>1</sub>	L <sub>1</sub>	Minimum Compressive	Minimum Shear Force
		min	max						KN	KN
Φ6.4	13.7	1.50	3.50	6.7-6.9	13.4	3.4	4.2	27	8.8	10.5
+0.08	15.0	2.80	4.80						8.8	12.0
-0.15	15.6	3.35	5.35						8.8	12.5
	17.0	4.80	6.80						8.8	12.5
	19.0	6.80	8.80						8.8	14.0
	19.7	7.50	9.50						8.8	15.0
	21.0	8.80	10.80						6.6-6.8	8.8
	23.0	10.80	12.80	8.8	16.0					
	25.0	12.80	14.80	8.8	16.0					

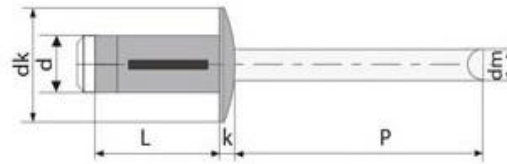

**Steel/Steel  
Blind Rivet  
Dome Head**

Length Unit: mm

d	L ±0.99	Grip Range		Hole Size Φ	dk	k max	dm max	p min	Minimum Compressive	Minimum Shear Force
		min	max						KN	KN
Φ4.8 +0.08 -0.15	11.5	3.50	6.00	4.9-5.1	8.8	2.1	3.1	27	3.3	2.9
	14.0	6.00	8.00						3.3	3.9
	16.5	8.50	11.00						3.3	4.9
	19.0	11.00	13.50						3.3	5.8
Φ6.4 +0.08 -0.15	11.5	3.80	5.80	6.7-6.9	10.2	2.5	4.2	27	5.4	5.3
	13.5	5.80	7.80						5.4	7.3
	15.5	7.80	9.80						5.4	9.3
	17.5	9.80	11.80						5.4	10.0
	19.5	11.80	13.80						5.4	10.0
	21.5	13.80	15.80						5.4	10.0
	23.5	15.80	17.80						5.4	10.0
	25.5	17.80	19.80						5.4	10.0
	27.5	19.80	21.80						5.4	10.0
29.5	21.80	23.80	5.4	10.0						